

yellow bins
 bags
 orange
 purple
 tiger striped
 yellow labelled

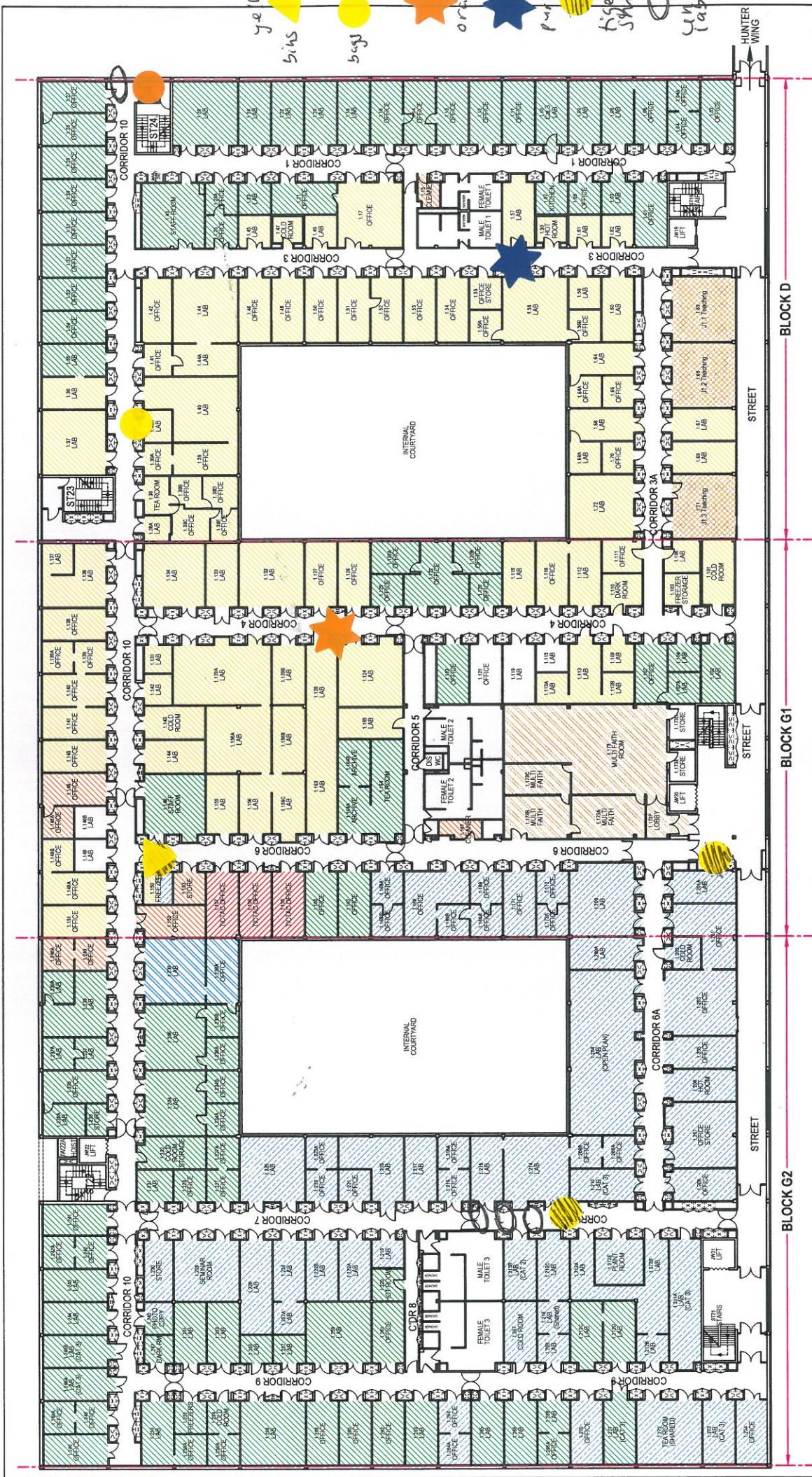

BLOCK D
 BLOCK G1
 BLOCK G2

Jenner 1st Floor

DEPARTMENT OCCUPATION DETAILS

- SOCIAL
- GIR
- CENS
- BMC
- CS
- NHS
- COMMERCE
- Academic

Estates & Facilities Cranmer Building Telephone: 020 8725 9844 Facsimile: 020 8725 0880 www.sgul.ac.uk		Revision Date: 18/02/2009 13/07/2009 30/07/2010 10/05/2011 09/01/2012 12/09/2012 07/04/2014		Revision Details: DEPARTMENT OCCUPATION AREAS INDICATED FOR DISCUSSION LAYOUT & OCCUPATION UPDATED DEPARTMENT LAYOUT UPDATED TICTAC & CLEANER UPDATED LAYOUT UPDATED - TEACHING AREAS REMAINED LAYOUT UPDATED PER SURVEY BY DIRECTOR OF PLANNING LAYOUT UPDATED TO INCLUDE AREA FOR SOUTH WEST LONDON PATHOLOGY		Drawing Title: JENNER BUILDING DEPT. OCCUPATION Drawing Floor Level: LEVEL 1		Date Issued: 07/04/2014 Drawing No: JW/L1/AB/008		Drawn By: DH Checked By: DH Checked By: TW	
		Scale: N/A		Rev. No. Rev. By. Checked By.		01 DH IP 02 DH IP 03 DH IP 04 DH IP 05 DH IP 06 DH TW 07 DH DB					



© COPYRIGHT
 No part of this drawing may be
 reproduced without the written permission
 of St Georges University of London
 Estates & Facilities